

# Accora



## Configura® Bariatric 40 stone, Bariatric 40 stone Tilt-in-space and Bariatric 50 stone Dual Motor Instruction Manual

IFU-CFB-001EN Rev 07

---

## Contents

Introduction	3	Initial Installation	20
Moving and handling	3	Troubleshooting	21
Size	5	Warnings	22
Pressure	5	Regulations	22
Posture	6	Cleaning Recommendations	24
Identification	6	General Protection	25
Assessment	7	Electrical Limitations	25
Adjusting the Seat Depth	7	Weight and Dimensions	26
Changing the Pressure Cushions	8	Guarantee	26
Fitting the Tri-pos cushion	9	Contact Details	26
Changing the Headrest	9	Symbols	27
Removing filling from the Multi-adjustable Pillow Backrest	10		
Fitting the Channel Legrest	10		
Removing and Fitting the Backrest	11		
Using the Handset	14		
Power Backup	15		
Changing the Handset Side	15		
Removing and Fitting the Overlay	16		
Replacing the Armrests	17		
Replacing the Side Pieces	18		
Replacing the Handset	19		

## Introduction

These instructions apply to the Configura® Bariatric chair by Accora.

Please read them carefully before setting up and using the chair and keep them in a safe place for future reference.

These instructions include details of the performance of the chair. If the chair malfunctions, shows signs of damage or excessive wear, or otherwise feels unsuitable, please take it out of service and contact your supplier immediately.

The Configura® Bariatric is designed to be configured to suit a range of different size, pressure and posture requirements.

## Moving and handling

Moving and handling can be challenging on the bariatric chair due to its size and weight. However, there are ways to make it as easy and safe as possible.

We strongly recommend that Configura® Bariatric is delivered with 2 people. The total weight of the chair is 92kg including the backrest. The chair base alone weighs 72kg and the backrest weighs 20kg.

The following process should make it as easy as possible:

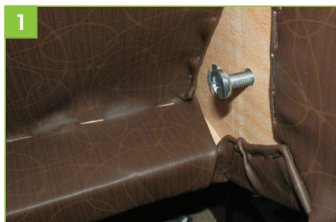

Remove backrest – remember to remove the screws securing the backrest brackets on the inside of the backrest.



Place all loose wires under the overlay to keep them out of the way.



With two people, lift the chair onto a trolley on its side (not the side with the handset).

- 
- 4) Manoeuvre chair into desired position
  - 5) Lower chair onto its base and off the trolley

*Note: this method allows you to get through quite narrow doorways as the chair is only as wide as it is high.*

## Chair set-up

The chair configuration is selected by a healthcare professional via the Configura® Bariatric Assessment form. If extra parts are required, they can be ordered separately from Accora.

For a copy of the Configura® Bariatric Assessment form or for a parts and accessories manual, please email [configura@accora.uk.com](mailto:configura@accora.uk.com)

To lift the Configura® Bariatric, the backrest must first be removed. Two people are required to lift the chair base.

## Weight capacity:

### **Bariatric 40 stone and Bariatric 40 stone Tilt-in-space Dual Motor**

**Total limit** = 40 stone

**Footrest limit** = 20 stone

### **Bariatric 50 stone Dual Motor**

**Total limit** = 50 stone

**Footrest limit** = 25 stone

Accora classifies the Configura® Bariatric as a configurable seating solution for varied and changing user needs. The ability to configure the size, pressure and posture requirements allows the chair to be used for many different user requirements. It is particularly suitable for Equipment Loan Store use as the chair can be easily re-issued. We strongly recommend that anybody issuing the Configura® has attended a Configura® Product Training Session. For details of these courses, contact [configura@accora.uk.com](mailto:configura@accora.uk.com)

The Configura® Bariatric is designed to offer the right size and to accommodate pressure care and postural requirements for different users.

The suitability and effectiveness of these features are dependent on correct chair set-up, which is dependent on three key elements:

- seat to floor height
- seat width
- seat depth

The Configura® should be regularly checked to ensure the set-up is correct and that it is working as intended for the user.





## Size

The Configura® Bariatric 40 stone can be adjusted to a number of sizes:

Seat width: 24", 26", 28"

Seat depth: 22", 20", 18"

Seat height: 18", 16"

The Configura® Bariatric 40 stone Tilt-in-space Dual Motor can be adjusted to a number of sizes:

Seat width: 24", 26", 28"

Seat depth: 22", 20", 18"

Seat height: 16", 18", 20"

The Configura® Bariatric 50 stone can be adjusted to a number of sizes:

Seat width: 30", 32", 34"

Seat depth: 22", 20", 18"

Seat height: 18"



## Pressure

Configura® has a number of pressure care options:

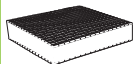

### Castellated (std)

Castellated, pressure reducing cushion for users who cannot tolerate Visco foam. Similar in performance to the Visco cushion.



### Visco

Heat sensitive memory foam moulds to the user providing maximum support and pressure reduction. Suitable for users who are at risk of pressure damage. 30 or 40 stone weight capacity, depending on weight capacity of cushion.



### Cushionair

Powered alternating air cushion which coupled with the memory foam and vapour permeable fabric of the overlay provides excellent comfort, stability and pressure relief. 45 stone weight capacity.



### Vapour Permeable fabric on Backrest

Visco and Vapour Permeable fabric on backrest to provide increased comfort and pressure reduction.



### Vapour Permeable fabric on Lateral Support Backrest

Vapour Permeable fabric on backrest to provide increased comfort and pressure reduction.



## Posture

Configura® has different options for posture management:



### Multi-adjustable Pillow Backrest (std)

Each pillow is height adjustable and the filling can be customised to the user. Offering mild to moderate postural support, the Multi-adjustable Pillow Backrest is highly effective for users with a kyphosis or a scoliosis.

### 2 x Lateral Supports

Lateral Supports to fit underneath the backrest pillows to provide lateral support combined with the comfort and adjustability of the Multi-adjustable Pillow Backrest.

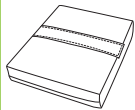

### 1/4 Depth Adjustment

For use with the Lateral Support Backrest to adjust its angle. Either to tilt it backwards or forwards or from one side to another.



### Profiled Headrest

Suitable for users with reduced head control.

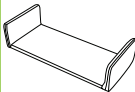

### Channel Legrest

Provides side support on legrest to reduce abduction.

## Identification

Each Configura® has an ID number on the base frame. This number must be quoted on any correspondence with Accora.

---

## Assessment

An individual assessment of the user's needs is essential prior to issuing Configura®. Assessment should be carried out by a competent healthcare professional with in depth knowledge and training on seating requirements. We also strongly recommend regular product training from Accora to ensure the prescriber is up to date with the features of the chair. Healthcare professionals should use the Configura® Assessment Form to help with the assessment.

## Adjusting the Seat Depth



Remove the bottom two cushions from the backrest.



Attach the 'Depth Adjustment Kit' with the Velcro at the top as shown.



Re-attach the two bottom cushions to the depth adjustment kit on the Velcro tabs provided. The top cushion fits as normal on the Velcro tab at the top of the backrest. Ensure the cushions are firmly fixed on the Velcro tabs provided.

---

## Changing the Pressure Cushions



Remove bottom cushion.

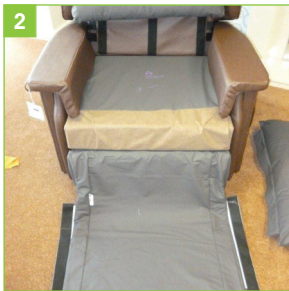

Remove overlay from the sides of the cushion and underneath the seat base at the back.



Remove existing cushion.



Fit new cushion fastening it in place using the flap at the front of the chair. See page 12 for instructions on refitting the Overlay.

---

## Fitting a Tri-pos cushion



The Tri-pos cushion requires a separate power supply to operate the electric pump. When installing the Tri-pos cushion, ensure the pipes are routed correctly through the back of the chair to avoid them catching and crushing when the chair is reclined. Also ensure that the power leads and pipes are positioned so they are clear of any walkways etc to minimise the risk of tripping. Test the pump and cushion to ensure it inflates correctly before use.

Please see the picture for correct routing of pipes.

***Note that they are below the horizontal bar of the chair mechanism.***

The weight capacity for the Tri-pos cushion is 45 stone.

The cushions and depth adjustment kit can be moved up and down on the velcro tabs to accommodate different postural requirements. Always ensure the cushions are firmly fixed on the velcro tabs before use. Filling can also be removed from the 'Multi-adjustable Pillow Backrest' as described below.

When removing the cushions on the Multi-adjustable Pillow Backrest, fold the Velcro flaps on the cushions back onto the cushions so that filling and dust does not get caught in the velcro. Use caution when using the lateral support backrest with the dual motor tilt-in-space mechanism as it introduces shear.

## Changing the Headrest



Remove the top pillow from the backrest.



Replace with Profiled headrest.

***Filling can be added or removed from the headrest as required.***

---

## Removing filling from the Multi-Adjustable Pillow Backrest

This is sometimes required to accommodate postural requirements such as a kyphosis.



Remove the cushion from the backrest and undo the zip at the back of the cushion.



Remove the filling from the white internal bag as required and refasten the zip on the cushion, ensuring that no filling is caught in the zip.

***Remember that the cushions take a few weeks to mould to the user so avoid taking out too much filling on initial set-up.***

## Fitting the Channel Legrest



Elevate the legrest.



Release the Velcro from the legrest section of the Overlay.



Place the Channel Legrest on top of the legrest section.



Refit the Overlay on top of the Channel Legrest. See page 12 for instructions on refitting the Overlay.

## Removing and fitting the backrest

### Notes:

- The backrest is a tight fit due to the user group this product is designed for. It is vital that the backrest is kept square and upright when removing and fitting otherwise it will jam.
- This process is easier with two people – one each side of the backrest.
- This process is also easier if the backrest cushions are removed making the backrest lighter.

---

## Removing

1



From the inside of the backrest, remove the screws securing the backrest brackets.

2

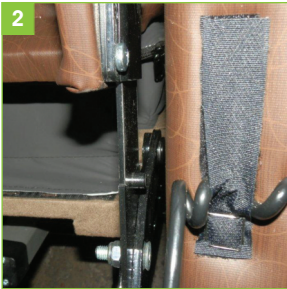

Loosen backrest brackets by applying upward pressure to the wings of the chair.

3



Remove backrest taking care to make sure it is kept dead upright.



---

## Fitting/re-fitting



Line backrest up as close as possible to the backrest brackets (it may sometimes be necessary to bend the brackets on the mechanism inwards slightly).

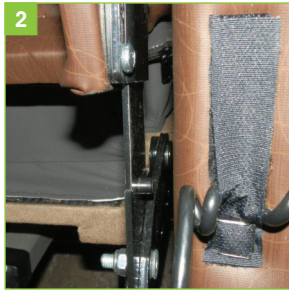

Insert one side of the backrest at a time, taking care to make sure the backrest remains square and upright.

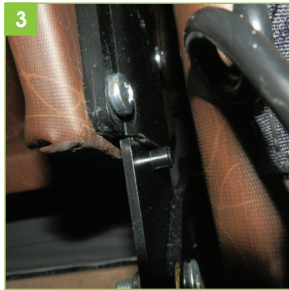

Carefully push the backrest down into place until the backrest bracket hits the stopper on the mechanism bracket taking care to make sure the backrest remains square and upright.

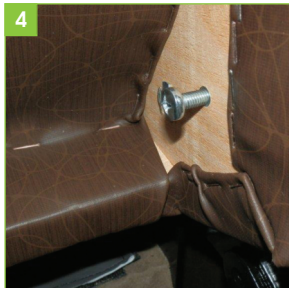

Fit screws securing the backrest brackets on the inside of the backrest.

# Using the Handset for Bariatric 40 stone Dual Motor and Bariatric 50 stone Dual Motor

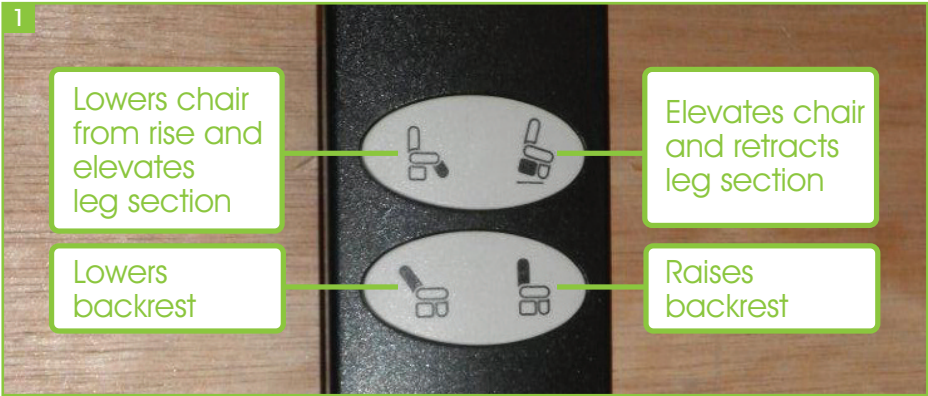

# Using the Handset for Bariatric 40 stone Tilt-in-space Dual Motor

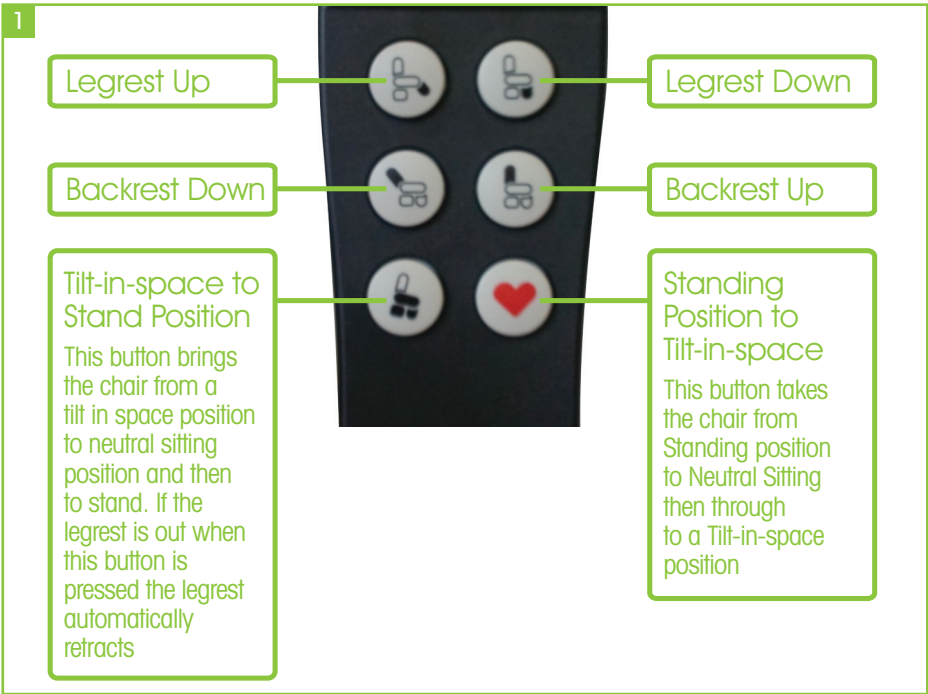

---

## Power Backup (Only on non Tilt-in-Space versions)



The transformer is fitted with a battery backup which allows the chair to be lowered in the event of a power failure. Replace the batteries by removing the small plastic cover on the side of the transformer.

## Changing the Handset



Remove the handset from the loop on the side of the chair.



Remove the handset from the Velcro loop at the back of the chair.

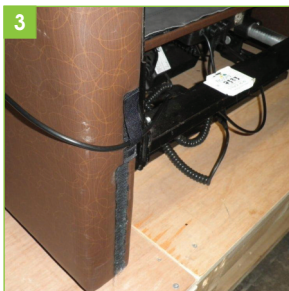

Fasten the cable with the Velcro loop on the other side of the chair.



Feed the handset through the loop on the other side of the chair.

## Removing and Fitting the Overlay

The overlay is fastened in three places: the legrest, the sides of the cushion and underneath the seat base at the back of the chair. Before removing or refitting the Overlay, raise the legrest until it is just below the horizontal position. This will give easy access to the Velcro and ensure that, when refitted, the Overlay is tensioned correctly.



Release the Velcro from the underneath the chair, the sides of the cushion and the legrest.



Replace overlay starting from the legrest, then underneath the seat base, then the sides of the cushion.

It is easier to access the Velcro fastening underneath the seat base if the backrest is removed. When fitting, always ensure that the overlay is secure on the Velcro fastening tabs.

## Replacing the Armrests

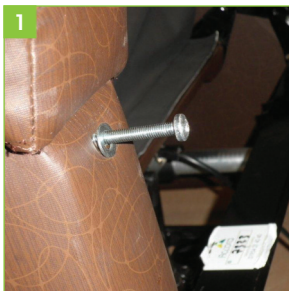

Using a cross-headed screwdriver, remove the screw from the back of the armrest.



Tap armrest towards the back of the chair so it comes loose. Slide the armrest out.



Remove the armrests from the side piece.



Retighten the screw at the back of the armrest.

## Replacing the Side Pieces

The side pieces on the Configura® Bariatric can be removed for easier moving and handling.

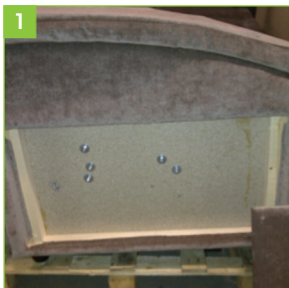

Remove the side panel using a cross head screwdriver (the small screw covers can be removed by hand).



Undo the bolts securing the side piece to the mechanism.

Remove the side pieces for easier moving & handling.  
Reverse the above process for reassembling the chair.

---

## Replacing the Handset



Disconnect the chair from the power supply.



Remove the handset from the handset loop and Velcro loop at the back of the chair.

Trace where the cable is routed underneath the chair to the control box.

Cut the zip ties fastening the handset lead to the mechanism.

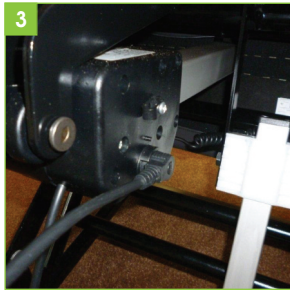

Disconnect the handset plug from the control box.

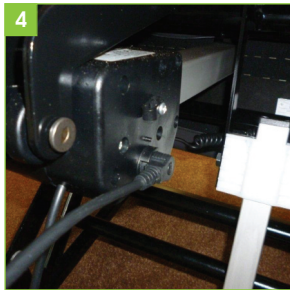

Connect the new handset plug into control box.

Use new zip ties to fasten new handset lead to mechanism in the appropriate places.

Fit the handset into the Velcro loop at the back of the chair.





Fit the handset into the handset loop.



Connect chair to power supply and lower the chair.

## Initial Installation



Prior to installation and use, please ensure the chair will not be hindered by any object as this will affect the performance and could damage the mechanism.

- Position the chair free from any obstruction and trailing wires.
- Position the back onto the brackets and refit the cover at the back of the chair. You will find a locking clip attached to the bracket, which should be pushed away from you to lock the back into position.
- The chair should be positioned with enough room for the chair to fully recline.
- There will be an extension cable located at the rear of this chair. For safety reasons and before connecting to the transformer, check that this cable has not been damaged in transit.
- After connecting the transformer, plug the unit into the power source and switch on power on ready for use.



- Please do not plug the Configura® into an extension lead. The chair must have a dedicated power supply.

**Note: This product is not unsafe when power is left on.**

- When moving or handling the chair DO NOT use the backrest, use the base only. Using the backrest may cause damage to the internal framework of the chair.
- When installing the Tri-pos cushion, ensure the pipes are routed correctly through the back of the chair in the middle to avoid them catching and crushing when the chair is reclined. Also ensure that the power leads and pipes are positioned so they are clear of any walkways etc to minimise the risk of tripping. Test the pump and cushion to ensure it inflates correctly before use. The Tri-pos cushion should be checked daily for correct operation.
- Do not put heavy weights in the pocket.
- **Do not lift the Configura® by the armrests.**

## Troubleshooting

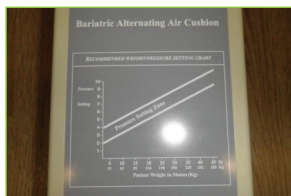

- Always disconnect the chair from the power before checking any part of the chair.
- Check the wall socket is in working order by trying another appliance.
- Check the connection from the chair to the transformer.
- Check to see if any of the cables are damaged; check fuse and batteries (where applicable).
- Store the hand controller in either the pocket or on the loop provided. This will ensure it does not suffer accidental damage.
- Do not allow children to play on or with the chair.
- Do not move the chair whilst a person is sitting in it. If you are in doubt about any of the above, please contact your supplier.
- If the Tri-pos cushion does not appear to be working, check the pipes are not kinked, the pump is switched on and that the pressure is set correctly.

---

## Warnings

- Do not allow children or animals to play with or near the chair.
- This chair is an electrical item and should be treated with caution.
- The motion lock-out control must be engaged when the chair is not in use.
- Take care when adjusting positions to avoid trapping or pinching of body parts.
- Always ensure that there is nothing to obstruct the free movement of the chair.
- Do not sit on footrest.
- Only the occupant or a trained carer should operate the chair.
- Do not fall into the chair as this could severely damage the chair and the mechanism.

## Regulations

### Flame retardancy

#### Main chair fabric

The fabric on the main body conforms to BSS852. Part 2 Source 5 (Crib).

#### Vapour permeable fabric (on seat base and legrest)

Flammability: BS7175 ignition 0.1 and 5 over CMHR foam.

#### Standard foam

The standard foam used in the chair (Kovafoam CME-3025) has been tested at FIRA International Limited and successfully satisfied the requirements from:

Schedule 1 part 1 of the Furniture and Furnishings (fire) (safety) Regulations 1988, amended 1989 and 1993 (based on BS 5852; 1982 part 2). Report reference: TFFLF16293.

#### Visco foam

The Visco foam on the Configura® meets the requirement of the Furniture and Furnishings (fire) (safety) Regulations 1988.

#### Tri-pos cushion

This cushion meets BS EN ISO 12952 parts 1 and 2 flammability test.

The Configura® Bariatric is a Medical Device Class 1 Medical Device in accordance with the Medical Devices Regulation 2002 as amended and the Medical Device Regulation 2017/745.

### Notice to User

If a serious incident occurs in relation to this medical device, affecting the user or the patient, then the user or patient should report the serious incident to the medical device manufacturer (or distributor) and, in the European Union, the user should also report the serious incident to the Competent Authority in the member state where they are located.



Accora Ltd, 38 Main Street,  
Swords, Co. Dublin, Ireland, K67 E0A2  
T: +353 (0)1 695 0614

---

## Fabric properties

### Duratek fabric

Type Of Fabric:	Jacquard / Dobby
Composition:	80% Polyester/20% Viscose
Customs code:	5516.23.00
Weight g/sq mt Non Fr:	470 / Weight g/sq mt Fr / 532
Abrasion:	BS EN ISO-12947-2: 1999, 12kpa load, 5000
Seam Slippage mm:	BS EN ISO 13936-2:2004
	Warp Way Seam - 1.7 Weft Way Seam - 1.5
Tensile strength N:	BS EN ISO-13934-1:1999
	Warp Way - 1999 Weft Way - 1456
Tear Resistance N:	BS EN ISO 13937-3:2000 Warp Way, Weft Way
Piling:	BS EN ISO 12945-2:2000
Visible Soiling	
Light Fastness:	BS EN ISO 105:BO2:1999, Method 3 to Standard 5, 5
Rubbing Fastness:	BS EN ISO 105-X 12:2002
	Dry 04-May / Wet 04-May
Fastness to Shampooing	
Water Fastness:	BS EN ISO 105-E01:1996
	Max Staining 3 / Change In Colour 3
Scuffing:	BS 2543 ANNEX D. As for woven pile fabric.
Flammability:	BS 5852 Part 1: 1979
	Ignition Source 0 - Pass / Ignition Source 1 - Pass
Flammability:	BS 5852 1990 Section 4 - Ignition Source Crib 5
Finishes Applied Teflon/Non:	None
Branded Stainguard	

### Vinyl

Design name:	Various
Manufacturer:	Panaz
Collection:	Cadet Contemporary
Quality:	WW901 – WW904 Cadet Contemporary
Composition:	Coating: 98% PVC 2% PU, substrate: 67% polyester 33% cotton
Weight:	720G/M <sup>2</sup>
Width:	137CM
Suitable applications:	Contract upholstery vinyl
Market sector:	Healthcare, leisure
Abrasion:	100,000+ Martindale abrasion rubs
Colour fastness:	5+
Flammability:	BS582 PART 2 SOURCE 5 (CRIB)
	EN1021.1/2
	NFPA 260

---

# Cleaning recommendations

- Clean and care for the fabric on a regular basis and it will maintain its condition and appearance. Most stains can be removed by wiping clean.
- The new generation of Microfibre cleaning cloths are extremely effective without soap for general care and maintenance.
- Wipe clean regularly with a damp cloth to remove dust particles and light soiling.
- Remove spillages promptly (within 15 minutes) with an absorbent dry cloth.
- For general soiling, use a soft brush with care to avoid abrasive damage to surface and tepid soapy water (non-alkaline). Rinse clean with clear water. Dry with an absorbent cloth.
- Bodily fluids should be removed promptly (within 15 minutes) with cold water then cleaned as above.
- Extreme soiling/infection control use a 5% Sodium Hypochlorite (Bleach) solution.
- Do not machine wash or dry clean.
- Do not apply other chemicals such as polish, solvents or stain removers.

## Additional information:

Built in anti-microbial/anti-fungal and high scratch resistance – colour solid to the base cloth.

## Vapour permeable fabric on seat base and legrest

Description: Polyurethane transfer coating on a weft knitted polyester fabric.

General properties:	Polyester fabric	
	Unembossed	
	Matt gloss level	
	Coating protected against fungi and bacteria	
	Washable at 75 degrees	
	Dry cleanable	
	Flammability: BS7175 ign 0.1 and 5 over CMHR foam.	
	Gentle to the skin	
	Physical properties:	
	Mean mass:	210 g/square metre
	Coating adhesion:	35 N/50mm (minimum)
	Water penetration	
	Resistance:	35Kpa (minimum)
	Tear strength:	
	Weft	50N (minimum)
	Warp	50N (minimum)
	Breaking load:	
	Warp	650 N/50mm (minimum)
	Weft	250 N/50mm (minimum)
	Extension at break:	
	Warp	85% (minimum)
	Weft	300% (minimum)

---

Mechanism and electrical equipment: All electrical parts meet the basic requirements of 2006/95/EG Low

Voltage Directive and 2004/108/EG Electromagnetic Compatibility Directive.

## General Protection

- Protect from the elements.
- Use only on a level debris free surface.
- Do not allow the mechanism to become waterlogged.
- Do not use abrasive cleaners on the mechanism.
- Do not use solvents or flammable fluids on the mechanism.

## Electrical Limitations

- Disconnect from the electrical supply before moving.
- Disconnect from the electrical supply before undertaking any maintenance.
- Use only genuine spare parts from the original manufacturer.
- The mechanism is designed to be unusable in the event of a power failure unless fitted with a battery backup or rechargeable system. The number of movements will depend on the system fitted together with any loading conditions prevailing.
- Do not increase the electrical fuse size in the plug top or attempt to connect any other mains connection to the appliance.
- Do not operate the controller for more than 2 minutes continuously in any 20 minute period.
- Do not cover the transformer; Air cooling is required.

---

## Weight and Dimensions

### Weight (please note these are approximate)

	Bariatric and Bariatric Tilt-in-space	Bariatric Supa
Complete chair	92kg	104kg
Backrest	20kg	25kg
Base part only including components	72kg	80kg

### Dimensions (please note these are approximate)

#### In normal sitting

Height	1150mm	1150mm
Width	1050mm	1300mm
Depth	800mm	800mm

#### In recline

Height	1050mm	1050mm
Width	1050mm	1050mm
Depth	1700mm	1700mm

#### In rise

Height	1450mm	1450mm
Width	1050mm	1050mm
Depth	1000mm	1000mm

Backrest height	1150mm	1150mm
Floor to top of arms	630mm	630mm
Arm height	200mm	200mm
Height to front of seat in rise	500mm	500mm
Height to back of seat in rise	650mm	650mm



## Guarantee

The warranty period for the Configura® Bariatric is 24 months, covering parts only. We require a purchase order for any parts despatched, warranty or otherwise. Any issues regarding warranty should be addressed in the first instance to your supplier.

## Contact Details

Accora Ltd., Charter House, Barrington Road, Orwell, Cambridge SG8 5QP  
T: 01223 206100, F: 01223 206120, E: [info@accora.care](mailto:info@accora.care)

# Symbols

	Complies with the European Medical Device Regulation 2017/745
	Complies with the Medical Devices Regulations 2002 as amended.
	Manufacturer
	EC Representative

# Accora



Accora  
Barrington Road  
Orwell  
Cambridge  
SG8 5QP  
United Kingdom

T: +44 (0) 1223 206100  
[info@accora.care](mailto:info@accora.care)  
[www.accora.care](http://www.accora.care)